

Manual Version 01

Make sure you have all the latest information needed to use and enjoy this product!

Visit ternbicycles.com/support for updated:

MANUALS

COMPATIBILITY

ARTICLES

VIDEOS

& MORE

⚠ We highly recommend watching the Sun Shield installation video on our Support site before you begin.

What’s Included

- Sun Shield x 1
- Ⓐ Long Pole x 2
- Ⓑ Tail Wing Pole x 1
- Ⓒ Roof Pole x 2

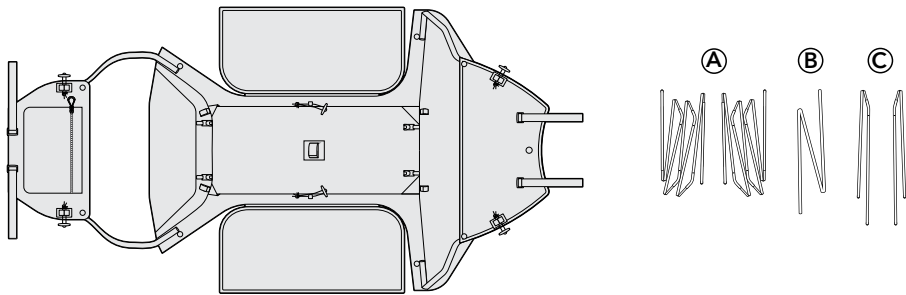

How to Assemble

Preparation

- Unfold Long Poles (A) and Roof Poles (C), pushing each section together to form single poles.
- Unfold and lay out Sun Shield, with the underside facing up.
- Smoothen and straighten Front & Rear Panel sleeves.
- Ensure Side Panels are unzipped.

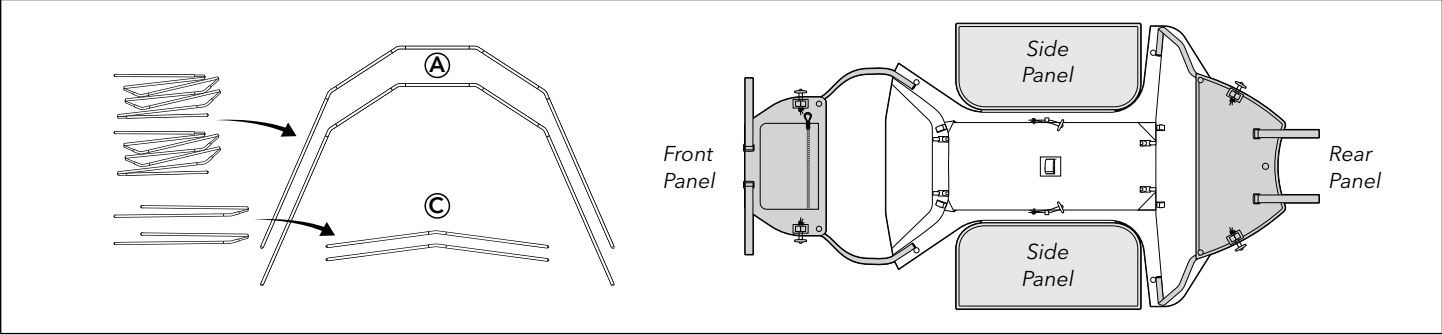

Assembly

⚠ Assemble Sun Shield in a free area, away from other people and pets.

1. Rear Panel

- Insert Long Pole (A) into rear panel sleeves (openings marked by red stitching). Make sure Pole reaches the end of both sleeves.
Tip: After fully inserting one side of the Pole, prop it against a wall and insert the other side.
- Clip Pole into plastic hooks and secure with self-fastening straps.

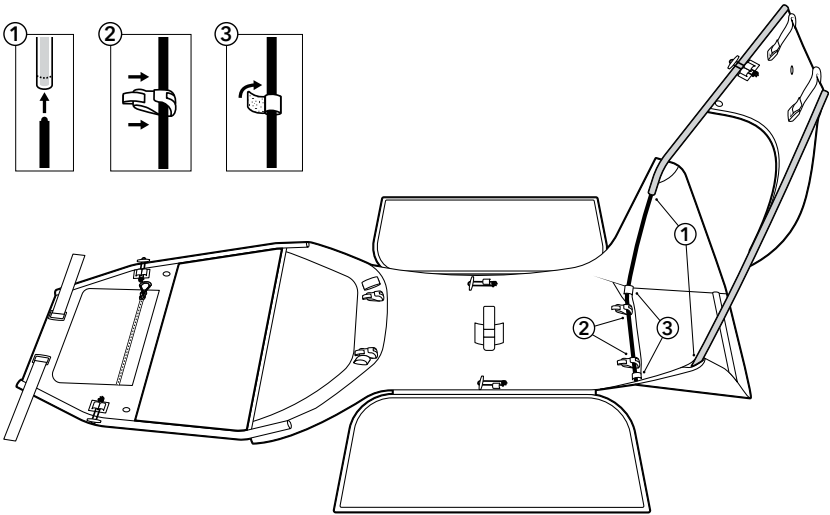

2. Tail Wing

- Insert Tail Wing Pole (B) into sleeve.

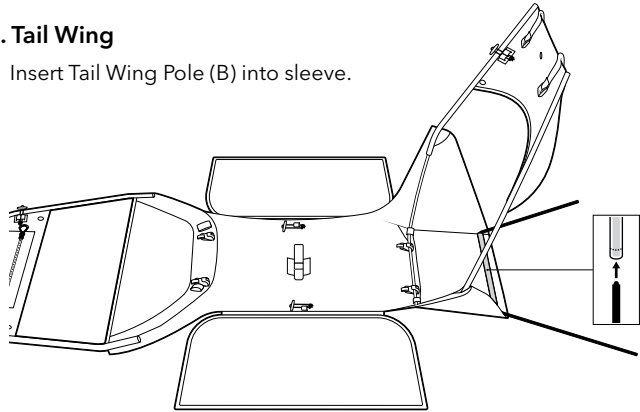

- Insert ends of Pole into triangular pockets.

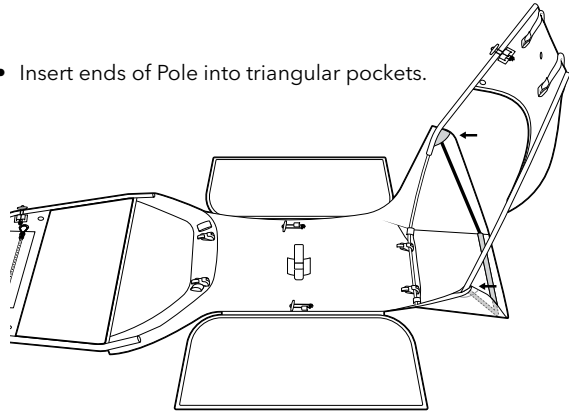

3. Front Panel

- Insert Long Pole (A) into front panel sleeves (openings marked by red stitching). Make sure Pole reaches the end of both sleeves.
Tip: After fully inserting one side of the Pole, prop it against a wall and insert the other side.
- Clip Pole into plastic hooks and secure with self-fastening straps.

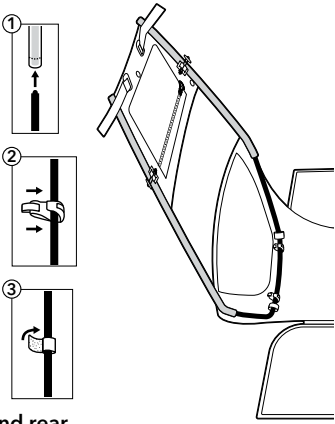

4. Roof

- Install Roof Poles (C) diagonally, arc-side up. First insert one end of Pole into larger triangular pocket, then insert other end into smaller triangular pocket. Repeat with other Pole.
- Push on arc of intersecting Poles to set Poles.
- Use self-fastening straps to secure Roof Poles in place.

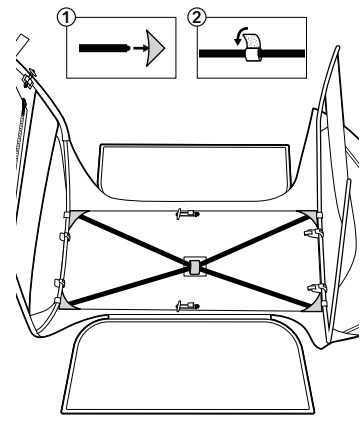

How to Install

- ⚠ A Clubhouse™ (sold separately) compatible with your bike must be equipped before Sun Shield can be installed.**
- ⚠ Clubhouse Mini™ of any generation is INCOMPATIBLE with Sun Shield.**
- Place Sun Shield over Clubhouse.
- Attach the four (4) elastic cords to Clubhouse knobs.
- Use self-fastening straps at the bottom of Front & Rear Panels to secure to Clubhouse.

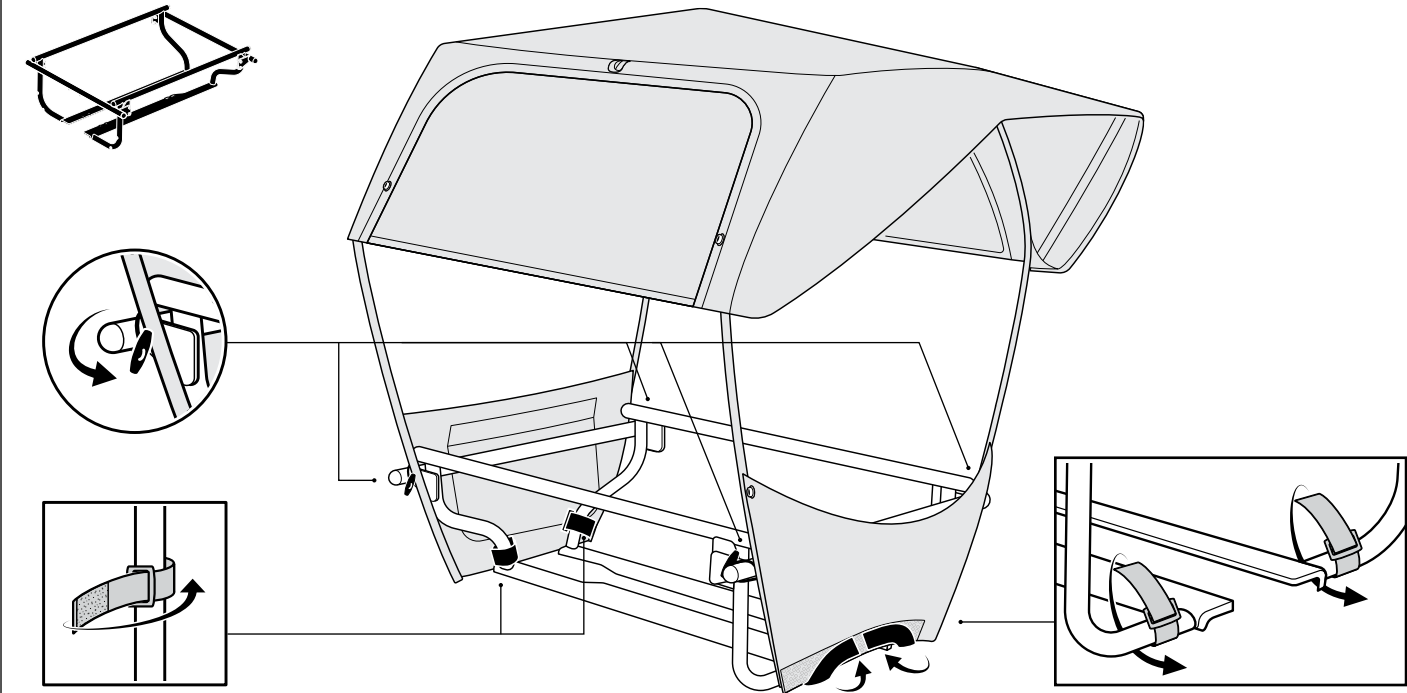

How to Stow Side Panels

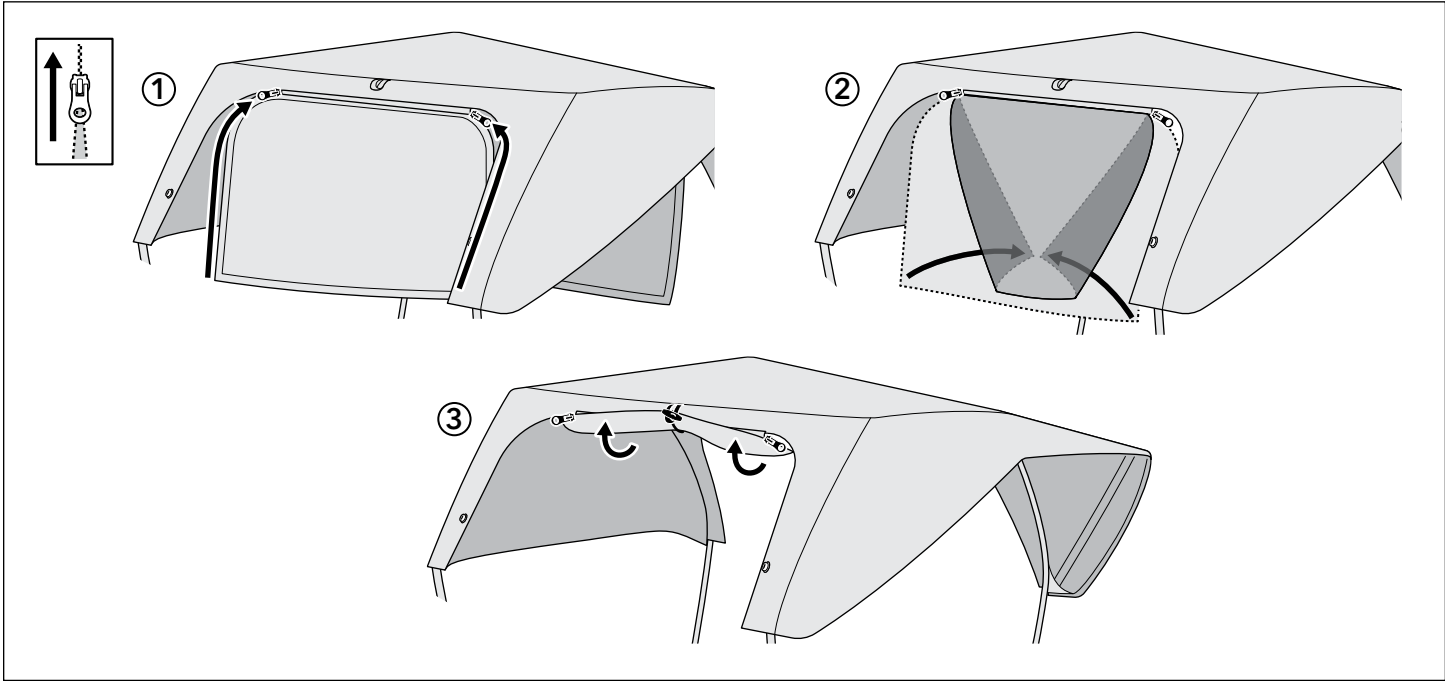

How to Fold Tail Wing

Folding the Tail Wing allows your bike to be vertically parked.

⚠ Clubhouse only supports vertical parking when Flat Bar is used. Expansion Bar will interfere with vertical parking.

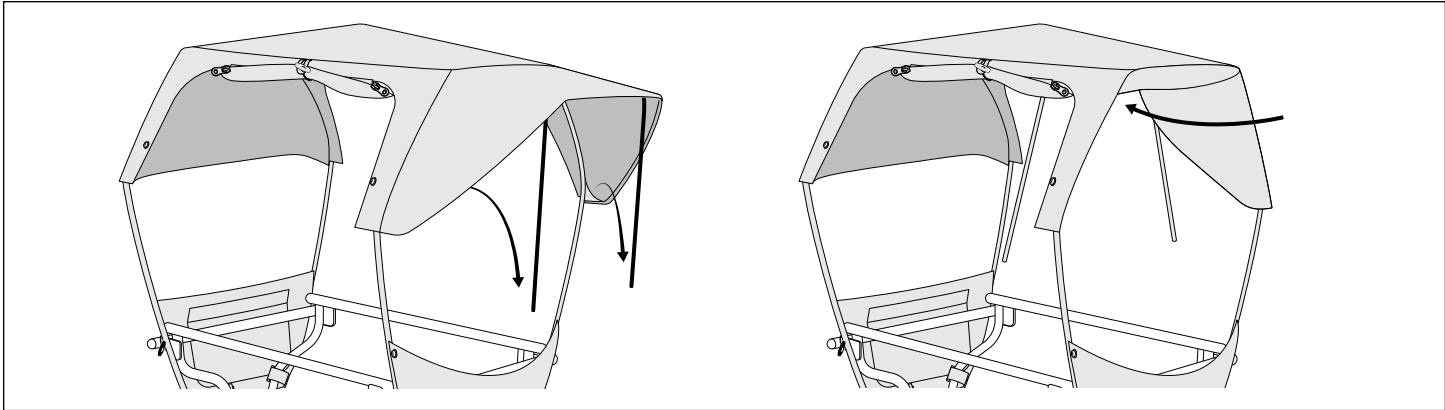

How to Clean

Wipe using dampened cloth with mild soap. Allow Sun Shield to fully dry before storing.

⚠ Do not use bleach or other harsh chemicals.

⚠ Do not machine wash or machine dry.

LIMITED PRODUCT WARRANTY INFORMATION: This Product comes with a ONE (1) YEAR Limited Warranty from the date of retail purchase by the original end-user. If a material or workmanship defect arises and a valid claim is received within the Warranty Period, this Product will be replaced. This warranty does not cover normal wear and tear, routine maintenance, or damages caused by misuse or improper care. For the full terms of this warranty, see ternbicycles.com/warranty.

TERN, tern (stylized), the Berd image, Sun Shield, Clubhouse, and Clubhouse Mini are registered trademarks of Mobility Holdings, Ltd. in the United States, EU, and other jurisdictions where they have been registered. In all other jurisdictions, Mobility Holdings, Ltd. asserts its rights in these marks to the fullest extent permitted by applicable law.

© 2025. Tern is a trademark of Mobility Holdings, Ltd. All Rights Reserved.

@ternbicycles

ternbicycles.com

Before carrying passengers, it's important to familiarize yourself with your bike's capabilities by referring to its user manual and/or QuickStart Guide.

⚠ Your bike may behave differently with passengers onboard.
Practice handling the bike in a safe area before riding with passengers on public roads.

Safety Notes

Follow the Law

- ⚠ Check your local regulations before carrying passengers:
 - Some jurisdictions do not allow the carrying of passengers on the back of a bicycle. Others may require specific accessories to do so.
 - Specific laws may apply to the carrying of child passengers on a bicycle.

Know Your Riding Condition

- ⚠ Both front and rear tires must always remain in contact with the ground when riding with passengers. No passenger is allowed when riding on unimproved or unmaintained trails with a natural surface, even if your bike is designed to handle such terrain.

Ensure Your Bike Setup is Safe & Secure

- ⚠ Before each trip, check that accessories have been correctly installed and secured, and ensure there are no loose items on the bike or on your passenger(s) that may get caught in moving bike parts. Keep sharp objects away from children, and suitably cover any coil springs (e.g. under the saddle) to prevent trapping of fingers.

Do NOT Leave Children Unattended

Do not allow your children to climb onto the bike nor leave your children unattended on the bike, even if it is on the kickstand. Wriggling children can upset the balance of the bike and a fall may result in serious injuries.

Use Proper Equipment

- ⚠ The bike must have the following accessories installed in order to safely transport rear passenger(s):

- 1. Seating.** Purpose-built rear seating, chosen according to the passenger's needs
- 2. Handhold.** Something for the passenger to hold on to, other than the bike itself
- 3. Foot support.** Fixed platforms or dedicated foot rests on both sides of the bike
- 4. Foot and leg protection.** Something to prevent feet and legs from getting caught in the spinning wheel
- 5. Double kickstand (optional).** Dual-leg kickstand with a wide stance that keeps a bike standing firmly on the ground, providing extra stability when loading and unloading a young passenger

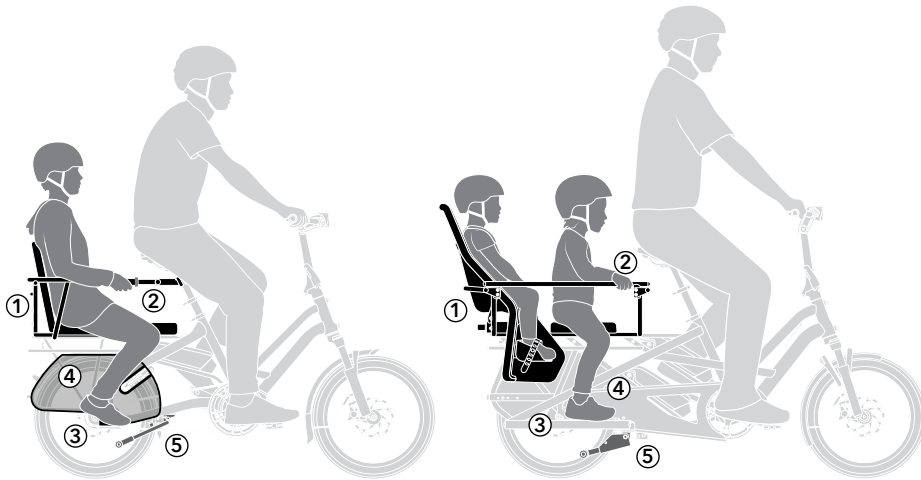

The illustrations above show a mix of suggested gear to safely carry passengers. Your combination of passenger accessories may differ depending on your needs. To learn more about how to safely carry passengers on your bike, visit ternbicycles.com.

Use Accessories Properly

If you're carrying young children on your bike, please follow the instructions provided by your child seat manufacturer for compatibility, installation, usage, and maintenance. To ensure your child's on-board safety, always use the restraint system provided by the manufacturer.

Only use child seats that are designed for your child's age and size. Your child passenger should be able to sit unaided, at least for the duration of the intended cycle journey. Always ensure your growing child's height and/or weight does not exceed the range recommended by the manufacturer.

Tern's seating, handhold, and foot support accessories are designed for use by seated rear passenger(s) only. Using them for unintended purposes such as lifting the bike or carrying substantial weight may cause damage to the bike and/or said accessories.

Follow Your Bike's Max Gross Vehicle Weight Limits

- ⚠ Check your bike's user manual and/or QuickStart Guide for information about maximum gross vehicle weight* and/or cargo weight** limits. Please do not exceed these weight limits.



* Maximum gross vehicle weight is the total weight of the bike, riders (the cyclist and any passengers), accessories, and cargo.

** Cargo weight is the total weight of passengers, accessories, and cargo.

Helmet Use

Mandatory helmet use vary across jurisdictions, so make sure to follow your local regulations. For safety, we strongly advise rider and passenger(s) to wear an approved helmet.



Scan to view available passenger accessories